

HERTFORDSHIRE COUNTY COUNCIL
ROAD TRAFFIC REGULATION ACT 1984

Date of Order: 4 January 2013
Order No: 7680

THE HERTFORDSHIRE (VARIOUS ROADS, ST ALBANS) (20 MPH SPEED LIMIT) ORDER 2011

The Hertfordshire County Council in exercise of their powers under Section 84 of the Road Traffic Regulation Act 1984 (hereinafter referred to as "the Act of 1984") and Part IV of Schedule 9 of the Act of 1984 and of all other enabling powers and after consultation with the Chief Officer of Police in accordance with Part III of Schedule 9 of the Act of 1984 hereby make the following Order:-

1. This Order may be cited as "The Hertfordshire (Various Roads, St Albans) (20 mph Speed Limit) Order 2011" and shall come into operation on Monday 14 January 2013.
2. No person shall drive any motor vehicle at a speed exceeding 20 miles per hour on those lengths of roads in St Albans as specified in the Schedule to this Order.
3. No speed limit imposed by this Order applies to vehicles falling within Regulation 3(4) of the Road Traffic Exemptions (Special Forces) (Variation and Amendment) Regulations 2011 when used in accordance with Regulation 3(5) of those Regulations.
4. For the avoidance of doubt where a length of road is described by Article 2 and the Schedule to this Order as being subject to a 20 mph speed limit, that restriction shall apply to the whole width of the roads so described and in all directions along those said lengths of road.
5. The provisions of the following Orders are hereby revoked;

The Hertfordshire (George Street, High Street and Verulam Road, St Albans) (20 mph Speed Limit) Order 2003

The Hertfordshire (St Peters Street, Chequers Street, Victoria Street and Adelaide Street, St Albans) (20 mph Speed Limit) Order 2004
6. The Interpretation Act 1978 shall apply for the interpretation of this Order as it applies for the interpretation of an Act of Parliament.

SCHEDULE

lengths of road in St Albans – 20 mph speed limit

The following roads are affected as specified

| | |
|--------------------|--|
| St Michaels Street | from a point 19 metres south east of its junction with Hemel Hempstead Road to its junction with Branch Road. A distance of approximately 430 metres |
| Kingsbury Avenue | from a point 6 metres south west of its junction with Verulam Road to its junction with Mount Pleasant. A distance of approximately 176 metres |
| Portland Street | from a point 6 metres south west of its junction with Verulam Road to its junction with Mount Pleasant. A distance of approximately 216 metres. |
| Hill Street | from a point 7 metres south west of its junction with Verulam Road to its junction with Mount Pleasant. A distance of approximately 228 metres. |
| New England Street | from a point 8 metres south west of its junction with Verulam Road to its junction with Mount Pleasant. A distance of approximately 198 metres. |
| Knights Orchard | from a point 8 metres south west of its junction with Verulam Road for its entire length. A distance of approximately 40 metres. |
| College Street | from a point 10 metres south west of its junction with Verulam Road to its junction with Lower Dagnall Street. A distance of approximately 120 metres. |
| Verulam Road | from a point 18 metres north west of its junction with Britton Avenue to its junction with High Street. A distance of approximately 286 metres. |

| | |
|------------------|--|
| Church Crescent | from a point 6 metres south of its junction with Folly Lane to a point 8 metres north east of its junction with Verulam Road. A distance of approximately 200 metres |
| Holywell Hill | from its junction with London Road to a point 71 metres north east of its junction with Albert Street. A distance of approximately 134 metres. |
| Monastery Close | from its junction with Abbey Mill Lane to a point 13 metres south east of that junction. |
| London Road | from its junction with Chequer Street to a point 60 metres north west of a point in line with the boundary between 11 and 13a London Road. A distance of approximately 112 metres |
| Victoria Street | from its junction with Chequer Street to a point 30 metres north west of a point in line with the north west wall of 15 Victoria Street. A distance of approximately 44 metres |
| Gombards | from a point 8 metres south west of its junction with Folly Lane to its junction with Worley Road. A distance of approximately 98 metres |
| Etna Road | from a point 6 metres south west of its junction with Catherine Street to its junction with Worley Road. A distance of approximately 138 metres. |
| Adelaide Street | from a point 9 metres south west of its junction with Catherine Street to its junction with St Peters Street. A distance of approximately 230 metres. |
| Catherine Street | from a point 10 metres north west of its junction with Drovers Way to its junction with St Peters Street. A distance of approximately 90 metres. |
| St Peters Street | from a point 18 metres south west of its junction with Catherine Street to its junctions with Chequer Street & Market Place, including the adjacent service Roads. A distance of approximately 400 metres. |
| Hatfield Road | from its junction with St Peters Street to a point 1 metre north west of a point in line with the north west boundary of 16 Hatfield Road. A distance of approximately 76 metres |

The following roads are affected for their entire lengths

Camlet Way, Branch Road, Fryth Mead, Prae Close, Blacksmiths Lane, Mount Pleasant, Bowes Lyon Mews, Kings Road, Fishpool Street, The Lawns, Offa Road, Ver Road, Abbey View Road, Temperance Street, College Place, Lower Dagnall Street, Romeland Hill, Romeland, Welclose Street, Old Garden Court, Spicer Street, Queen Street, Worley Road, Christchurch Close, George Street, , High Street, Upper Dagnall Street, Chequer Street, Market Place, Cross Street, Spencer Street, Britton Avenue, Russell Avenue, Waddington Road, Drovers Way, Selby Avenue, Upton Avenue, Stapley Road, Abbey Mill Lane and Orchard Street.

IN WITNESS whereof the Common Seal of the Hertfordshire County Council was hereunto affixed this 4th day of January 2013.

The Common Seal of)
Hertfordshire County Council)
was hereunto affixed)
in the presence of:)

K P Pettitt
Kathryn Pettitt



Chief Legal Officer

Computer File No.

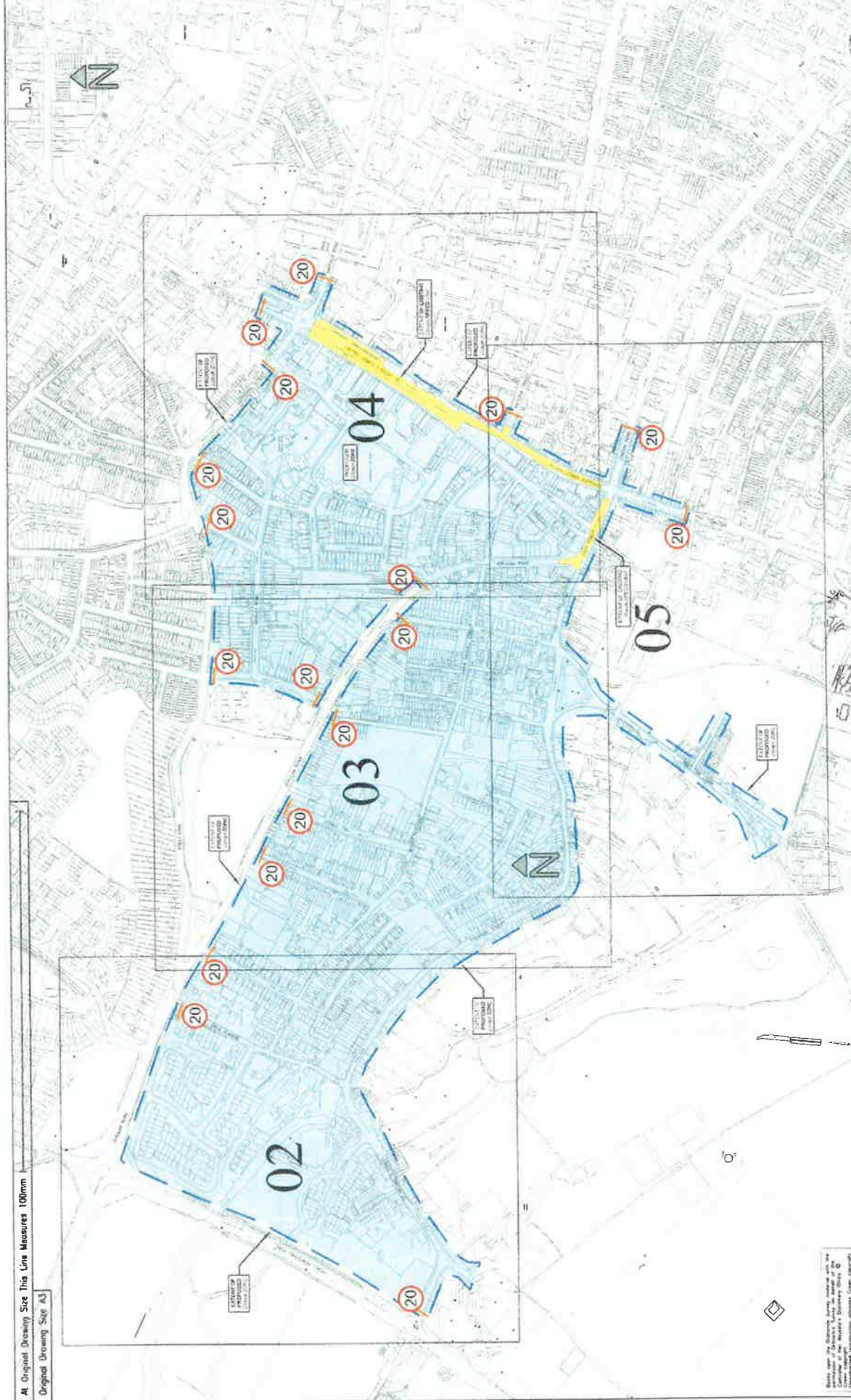

At Original Drawing Size This Line Measures 100mm
 Original Drawing Size A3

Notes

- EXTENT OF EXISTING 20MPH LIMIT
- EXTENT OF THE RECOMMENDED 20MPH ZONE
- PROPOSED LOCATION OF SPEED ZONE SIGNS (ON BOTH SIDES AS A GATEWAY FEATURE)

Hertfordshire Highways

Highways Team
 1st & 2nd Floor, 100 Broad Street
 Welwyn Garden City
 AL9 1QP

Tel: 01438 540000
 Fax: 01438 540000
 All 100P

| | |
|---------------|--|
| Project No. | M-ITP11027-S2-TRO-001 |
| Project Title | CATHEDRAL AREA 20MPH ZONE ST ALBANS |
| Drawing Title | TRO PLAN |

| | |
|-------------|-----------------|
| Project No. | 1036964 |
| Drawn | DR |
| Checked | DR |
| Date | JUN 11 / JUN 11 |
| Sheet No. | 1 of 1 |
| Scale | 1:5000 |

| | | | | |
|-----|----------|-----------------------------|-------|----------|
| Rev | Date | Comment | Drawn | Approved |
| A | 02/11/11 | Amended 20mph zone boundary | DR | DR |

| | | | |
|---------------------|-------------|-----------------------|-----|
| Revision with Dates | Project No. | Drg No | Rev |
| | 1036964 | M-ITP11027-S2-TRO-001 | |

This Drawing is the copyright of Hertfordshire County Council and must not be reproduced without written permission.

At Original Drawing Size This Line Measures 100mm
Original Drawing Size A3

Computer
File No.

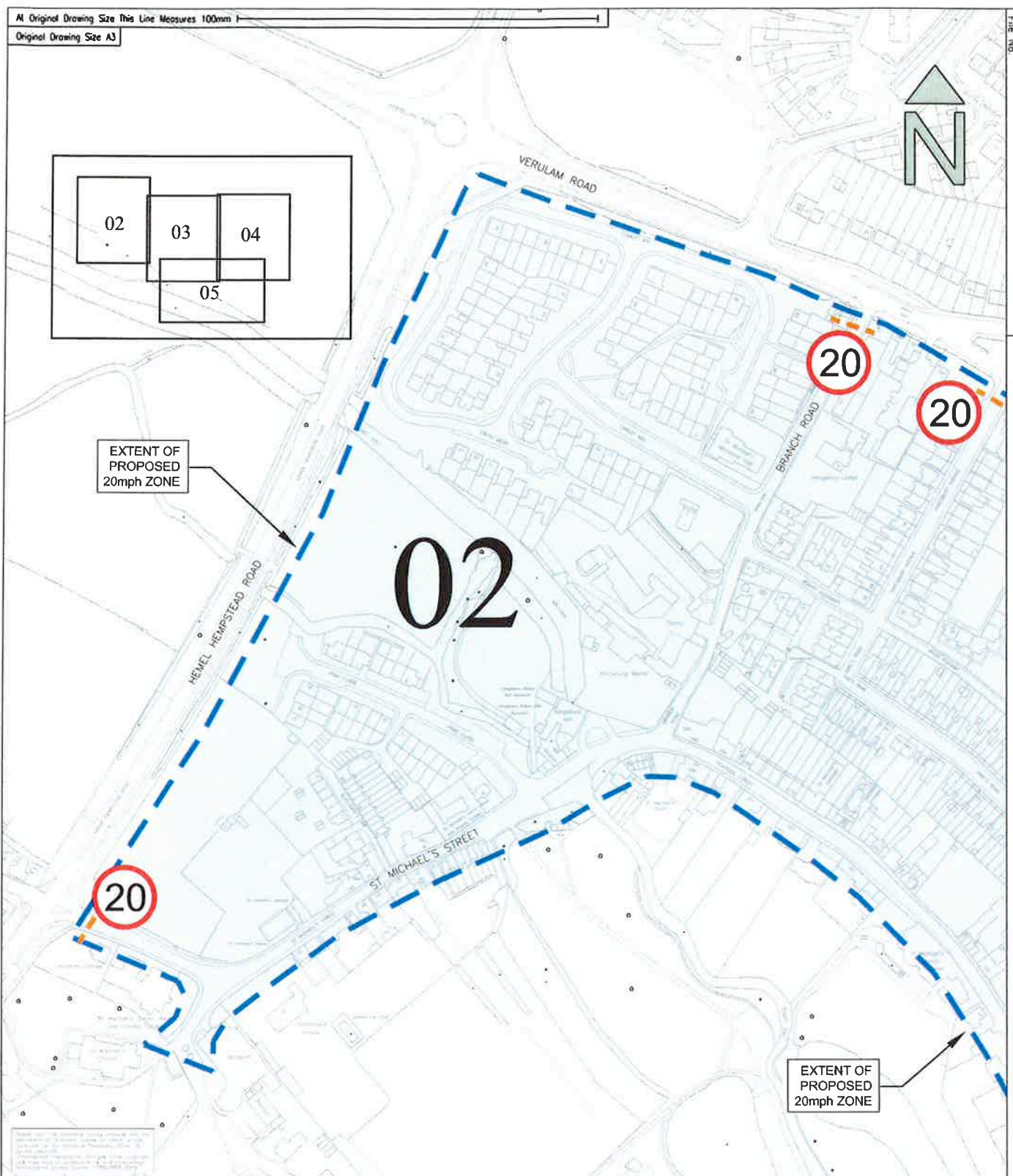
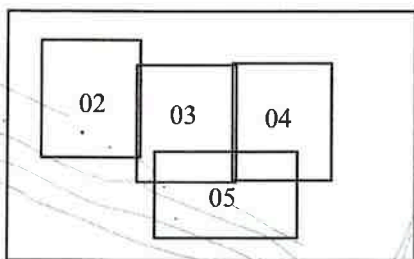

| Project No. 1036954 | | Drg. No. M-ITP-11027-S2-TRO-002 | | Rev. A | | | | | | | | | | | | | | | | | | |
|--|----------|---------------------------------|---------|----------|-----------|----------|-----------|----------|-----------------------------|----|----|--|--------|------|--------|--------|--|--|--|---------------|--|--|
| Revisions with Dates | | Project Title | | | | | | | | | | | | | | | | | | | | |
| <table border="1"> <thead> <tr> <th>Rev</th> <th>Date</th> <th>Comment</th> <th>Drawn</th> <th>Approved</th> </tr> </thead> <tbody> <tr> <td>A</td> <td>02/11/11</td> <td>Amended 20mph zone boundary</td> <td>DR</td> <td>SR</td> </tr> </tbody> </table> | | Rev | Date | Comment | Drawn | Approved | A | 02/11/11 | Amended 20mph zone boundary | DR | SR | CATHEDRAL AREA 20MPH ZONE ST ALBANS | | | | | | | | | | |
| Rev | Date | Comment | Drawn | Approved | | | | | | | | | | | | | | | | | | |
| A | 02/11/11 | Amended 20mph zone boundary | DR | SR | | | | | | | | | | | | | | | | | | |
| <table border="1"> <thead> <tr> <th></th> <th>CAD</th> <th>Drawn</th> <th>Checked</th> <th>Approved</th> <th>Sheet No.</th> </tr> </thead> <tbody> <tr> <td>Initials</td> <td>DR</td> <td>DR</td> <td></td> <td></td> <td>1:2500</td> </tr> <tr> <td>Date</td> <td>JUN 11</td> <td>JUN 11</td> <td></td> <td></td> <td></td> </tr> </tbody> </table> | | | CAD | Drawn | Checked | Approved | Sheet No. | Initials | DR | DR | | | 1:2500 | Date | JUN 11 | JUN 11 | | | | Drawing Title | | |
| | CAD | Drawn | Checked | Approved | Sheet No. | | | | | | | | | | | | | | | | | |
| Initials | DR | DR | | | 1:2500 | | | | | | | | | | | | | | | | | |
| Date | JUN 11 | JUN 11 | | | | | | | | | | | | | | | | | | | | |
| | | TRO PLAN | | | | | | | | | | | | | | | | | | | | |



Hertfordshire
Highways

Highways House
41-43 Broadwater Road
Welwyn Garden City
AL7 1JP
Tel: 01707 356200
Fax: 01707 356380

This Drawing is the copyright of Hertfordshire County Council and Must Not be Reproduced Without Written Permission

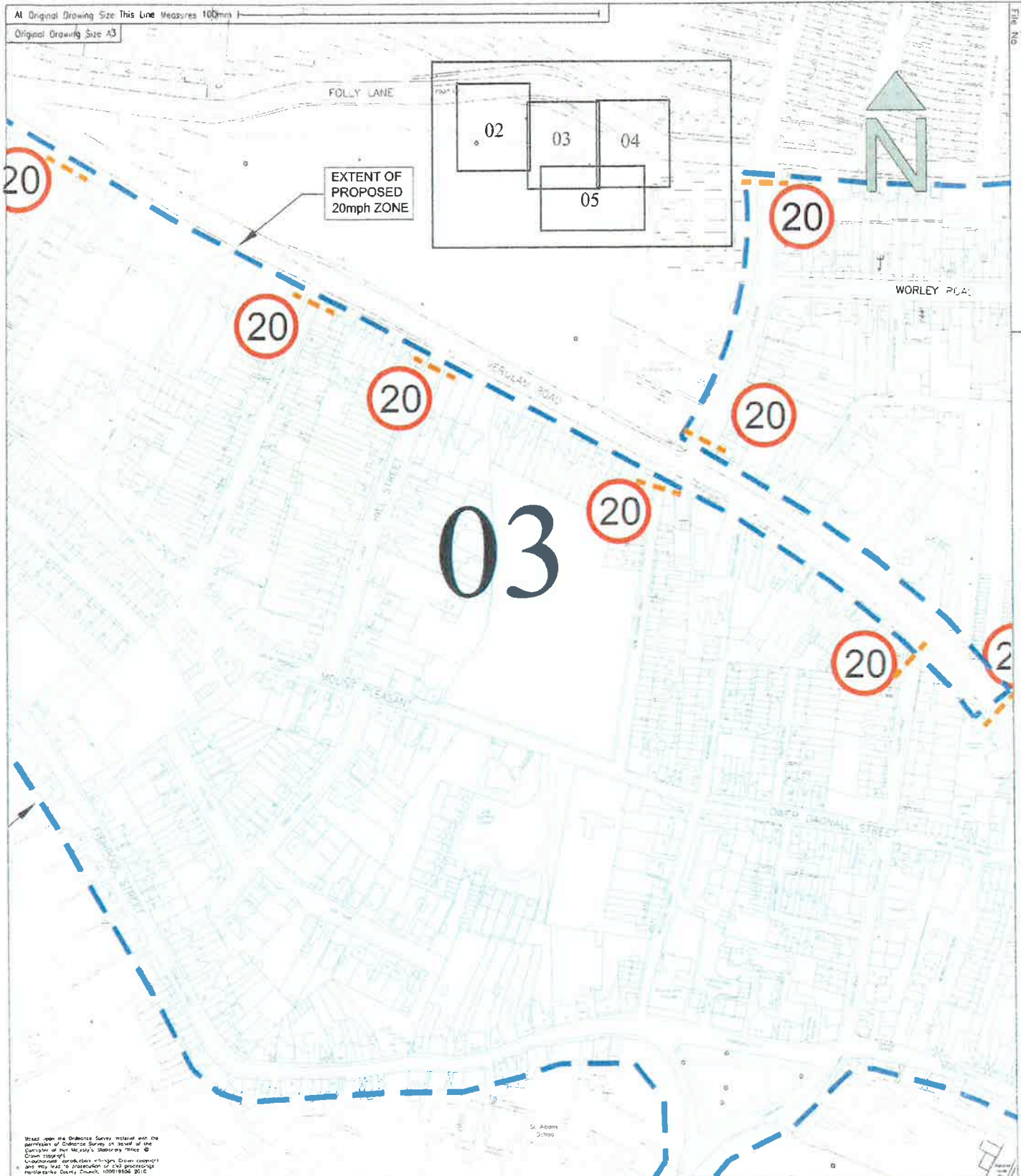

Must open the Ordnance Survey material with the permission of Ordnance Survey in respect of the Copyright of the Ordnance Survey (licensing since the Copyright, reproduction in any form, copyright and the use of the Ordnance Survey name and logo. Ordnance Survey, 100019506 2010.

| | | | | | | | | | |
|----------------------|--------|---------|---------|--|----------|------------------------|--|-----|--|
| Project No | | 1036954 | | Drg. No | | M-ITP-11027-S2-TRO-003 | | Rev | |
| Revisions with Dates | | | | Project Title | | | | | |
| | | | | CATHEDRAL AREA 20MPH ZONE ST ALBANS | | | | | |
| | | | | Drawing Title | | | | | |
| | | | | TRO PLAN | | | | | |
| | CAD | Drawn | Checked | Approved | Sheet No | | | | |
| DATE | DR | DR | | | Scales | | | | |
| Date | JUN 11 | JUN11 | | | 1:2500 | | | | |

Hertfordshire Highways

Highways House
41-45 Broadwater Road
Welwyn Garden City
AL7 3SP
Tel: 01707 356300
Fax: 01707 356380

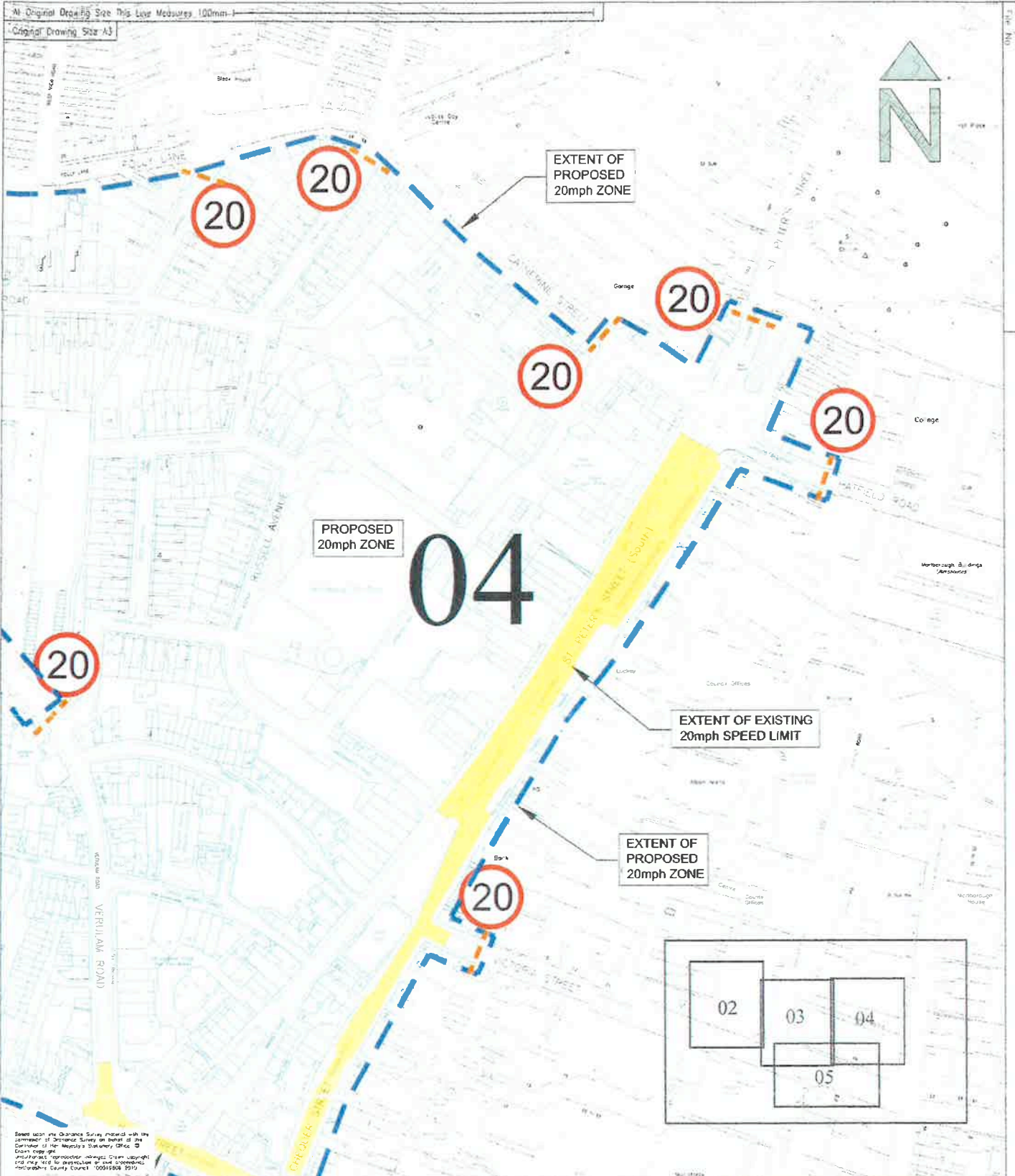

Based upon the Ordnance Survey material with the permission of Ordnance Survey on behalf of the Controller of Her Majesty's Stationery Office. Crown Copyright. Reproduction by permission of the Controller. Hertfordshire County Council 00015008 0910

| | | | |
|----------------------|--------|---------|----------|
| Project No | | 1036954 | |
| Revisions with Dates | | | |
| CAD | Drawn | Checked | Approved |
| Initials | DR | DR | |
| Date | JUN 11 | JUN 11 | |
| Sheet No | | 1:2500 | |

| | | | |
|---------------|------------------------|--|--|
| Drg. No | M-ITP-11027-S2-TRO-004 | Rev | |
| Project Title | | CATHEDRAL AREA 20MPH ZONE ST ALBANS | |
| Drawing Title | | TRO PLAN | |

Hertfordshire Highways

Highways House
41-45 Broadwater Road
Welwyn Garden City
AL7 3SP

Tel: 01707 336200
Fax: 01707 356380

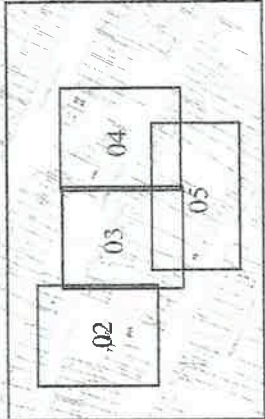
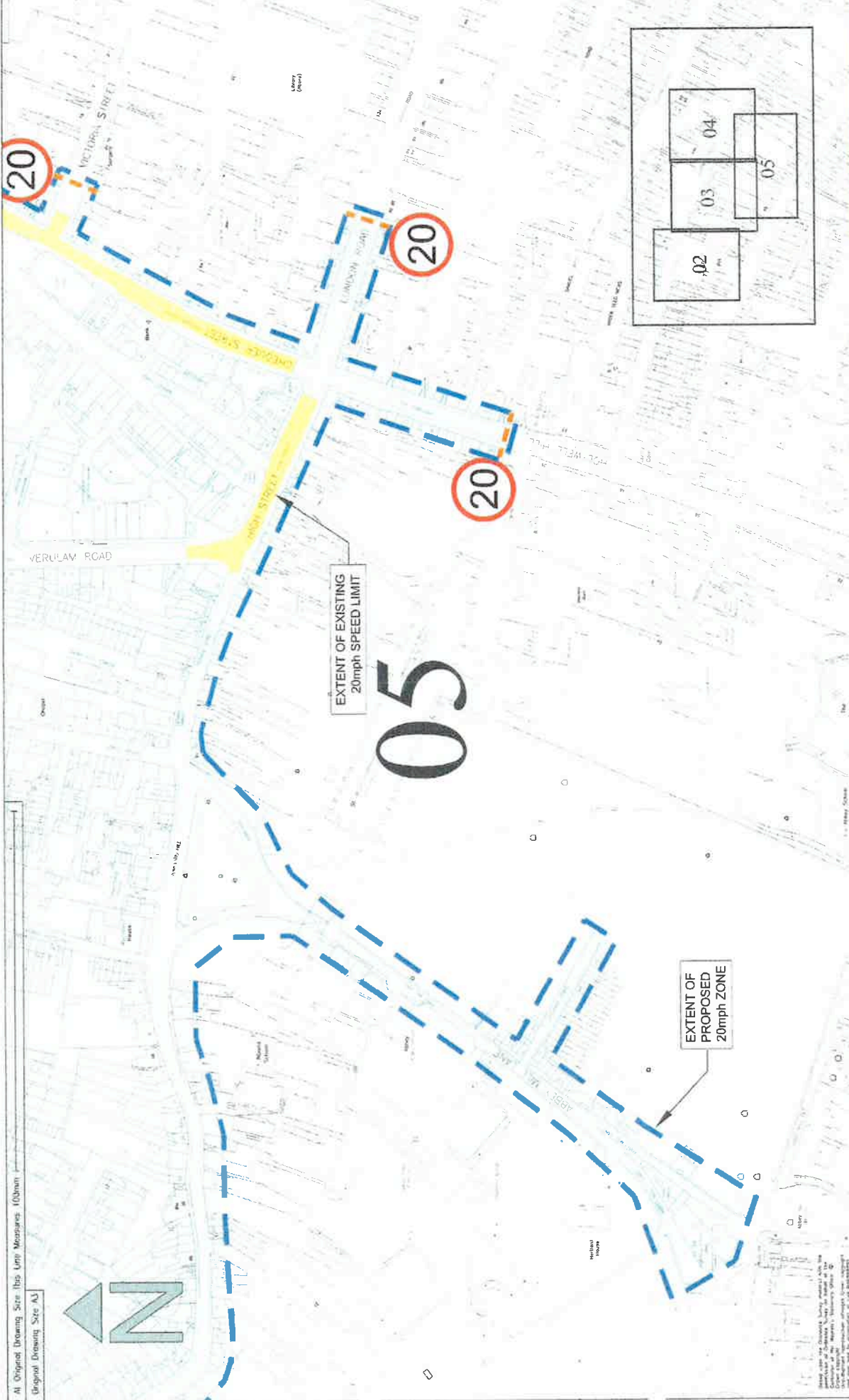

All Original Drawing Size 1100 Units Measure (0.0mm)
Original Drawing Size A3

Herfordshire Highways
 Highways Team
 146 Broadwater Road
 St Albans, Hertfordshire
 AL1 2SP
 Tel: 01763 340090
 Fax: 01763 346380

| | |
|---------------|--|
| Project No. | 1036954 |
| Drg. No. | M-TP11027-S2-TRO-005 |
| Project Title | CATHEDRAL AREA 20MPH ZONE ST ALBANS |
| Drawing Title | TRO PLAN |
| Scale | 1:2500 |

| | |
|---------------------|--|
| Revision with Dates | |
| Rev | |

- Notes**
- EXTENT OF EXISTING 20MPH LIMIT
 - EXTENT OF THE RECOMMENDED 20MPH ZONE
 - PROPOSED LOCATION OF SPEED ZONE SIGNS (ON BOTH SIDES AS A GATEWAY FEATURE)

HERTFORDSHIRE COUNTY COUNCIL

THE HERTFORDSHIRE (VARIOUS ROADS, ST ALBANS) (20 MPH SPEED LIMIT) ORDER 2011

NOTICE is given that the Hertfordshire County Council has made an Order under the Road Traffic Regulation Act 1984 to introduce a 20 mph speed limit zone in St Albans, affecting roads as specified in the Schedule to this Notice. The Order will come into effect on Monday 14 January 2013.

Documents giving more detailed particulars of the Order may be inspected from 10 January 2013 to 21 February 2013 during normal office hours at the offices of St Albans City & District Council, Civic Centre, St Peters Street, St Albans or at Main Reception, Hertfordshire County Council, County Hall, Pegs Lane, Hertford; or viewed at www.hertsdirect.org/trafficorders by clicking on the relevant local area (Quoting Ref:SA/007/11)

Enquiries relating to the Order should be referred to the Highways Engineer concerned Chris Wilkinson tel: 0300 123 4047 or chris.wilkinson@hertfordshire.gov.uk

Any person wishing to question the validity of the Order, or of any provision contained in it, on the grounds that it is not within the powers conferred by the Road Traffic Regulation Act 1984, or on the grounds that any requirement of the Act or any Instrument made under it has not been complied with in relation to the Order, may within 6 weeks from the date of this Notice apply to the High Court for this purpose.

SCHEDULE - lengths of road in St Albans – 20 mph speed limit

The following roads are affected for their entire lengths:-

Camlet Way, Branch Road, Fryth Mead, Prae Close, Blacksmiths Lane, Mount Pleasant, Bowes Lyon Mews, Kings Road, Fishpool Street, The Lawns, Offa Road, Ver Road, Abbey View Road, Temperance Street, College Place, Lower Dagnall Street, Romeland Hill, Romeland, Welclose Street, Old Garden Court, Spicer Street, Queen Street, Worley Road, Christchurch Close, George Street, High Street, Upper Dagnall Street, Chequer Street, Market Place, Cross Street, Spencer Street, Britton Avenue, Russell Avenue, Waddington Road, Drovers Way, Selby Avenue, Upton Avenue, Stapley Road, Abbey Mill Lane and Orchard Street.

The following roads are affected in part only:-

St Michaels Street, Kingsbury Avenue, Portland Street, Hill Street, New England Street, Knights Orchard, College Street, Verulam Road, Church Crescent, Holywell Hill, Monastery Close, London Road, Victoria Street, Gombards, Etna Road, Adelaide Street, Catherine Street, St Peters Street and Hatfield Road.

County Hall
Hertford
Herts SG13 8DN

10 January 2013
John Wood
Chief Executive & Director of Environment

STATEMENT OF REASONS FOR PROPOSING

THE HERTFORDSHIRE (VARIOUS ROADS, ST ALBANS) (20 MPH SPEED LIMIT) ORDER 2011

The Hertfordshire County Council proposes to improve road safety by reducing vehicular speeds in areas of heavy pedestrian use by introducing a new 20 mph speed limit in St Albans.

The St Albans Urban Transport Plan has identified the roads and street surrounding the Cathedral in St Albans as a locality where, with limited work, a 20 mph zone could be introduced, they are as follows:-

- A 20 mph speed limit zone affecting Camlet Way, Fryth Mead, Prae Close, Blacksmiths Lane, Mount Pleasant, Kings Road, Fishpool Street, The Lawns, Offa Road, Ver Road, Abbey View Road, Temperance Street, College Place, Lower Dagnall Street, Romeland Hill, Romeland, Welclose Street, Old Garden Court, Spicer Street, Queen Street, Worley Road, Christchurch Close, George Street, Bowers Lyon Mews, High Street, Upper Dagnall Street, Chequer Street, Market Place, Cross Street, Spencer Street, Britton Avenue, Russell Avenue, Waddington Road, Drovers Way, Selby Avenue, Upton Avenue, Stapley Road, Abbey Mill Lane, Orchard Street Branch Road, St Michaels Street, Kingsbury Avenue, Portland Street, Hill Street, New England Street, Knights Orchard, College Street, Verulam Road, Church Crescent, Holywell Hill, Monastery Close, London Road, Victoria Street, Gombards, Etna Road, Adelaide Street, Catherine Street, St Peters Street and Hatfield Road.

Existing speed measurements have identified some streets where vehicles speeds are high and where it would be necessary to carry out some limited work to restrain speeds. These measures consist of 'Gateway' features to raise awareness of the changes in speed limit, revised parking arrangements and road narrowings.

Current Department for Transport (DfT) regulations and polices require the installation of speed reducing features with the introduction of 20 mph zones to ensure compliance with the new speed limit.

Approval has been received from the DfT to undertake a pilot in the County, subject to support from the informal consultation.

It appears to the Highway Authority that it is necessary and expedient to make the Order in the interests of highway safety for avoiding danger to persons or other traffic using the road and for preventing the likelihood of such danger arising. It is intended that the measures will improve safety in particular for vulnerable road users such as pedestrians and cyclists.

All the proposed measures have been subject to consultation with local and County Councillors representing the respective areas and St Albans City & District Council. The local Police, Ambulance, Fire and Rescue Services, Hertfordshire County Council Passenger Transport Unit and local residents have also been consulted.